

Motor Series MTS5

Stepper Motor 15°



Standard Data

Motor type		Permanent Magnet (PM) stepper motor
Electrical Enclosure	IP	40
Connections		Flexible Leads 22 AWG, 200mm length; ends stripped 10 mm
Life expectancy		3 years in continuous operation
Weight	g	140
Mounting		Any position by ears or screw clip

Technical Data

Steps per revolution		24		
Degree/step		15		
Winding Type		bipolar		
Standard Voltage	V	6	12	24
Resistance per winding	Ω	15	78	300
Winding Type		unipolar		
Standard Voltage	V	6	12	24
Resistance per winding	Ω	20	78	300
Winding temperature	$^{\circ}\text{C}$	105 max.		
Holding torque	Ncm	2.5	(MTSB5)	2.1 (MTSU5)
Axial Force	N	2		
Lateral Force	N	4		
Rotor inertia	gcm^2	6		

Dimensional Drawing

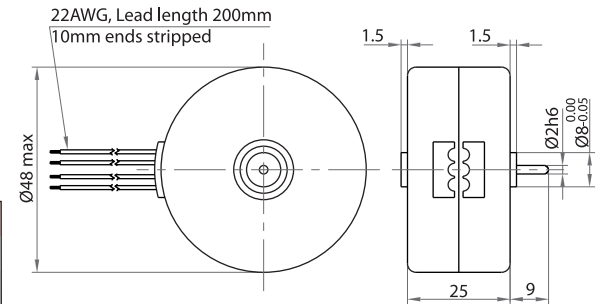

Ordering Data (eg.)

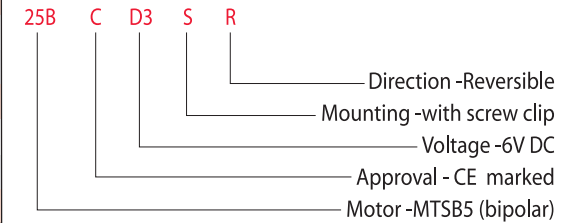

Torque Graphs

Start range (pull-in) with constant voltage power stage

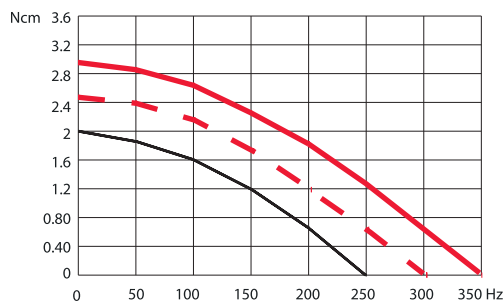

2-Phase stepper Motor MTSB5

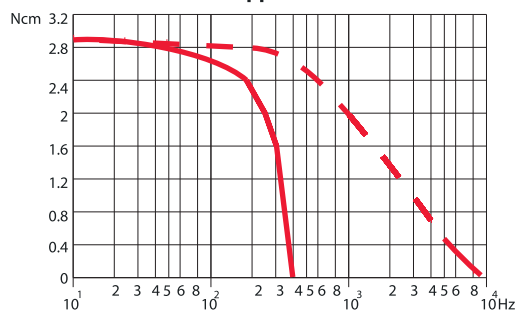

Slew range (pull-out) and start range (pull-in) with constant current power stage (chopper Drive)

Start range (pull-in) with constant voltage power stage

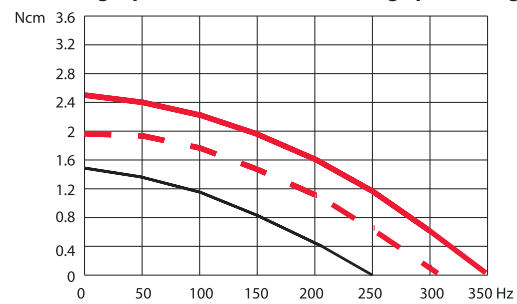

4-Phase Stepper Motor MTSU5

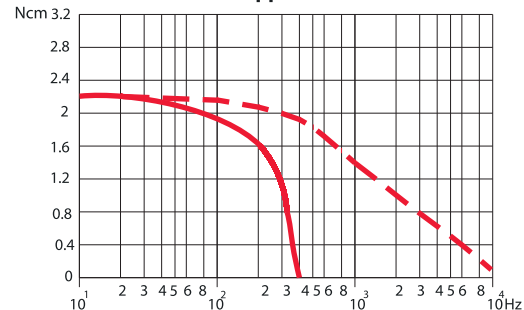

Slew range (pull-out) and start range (pull-in) with constant current power stage (chopper Drive)